

Square Towel Bar

- Back to back towel bar
- Suitable for : 8-12mm glass thickness
- Bar Thickness : 19mm
- Material : Stainless Steel



Finish: SSS, PSS, BL/PVD

Ref. No.	A	B	Glass Cutout
SHT450SQBB	19	450	Ø10
SHT600SQBB	19	600	Ø10

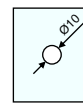

Glass Cutout

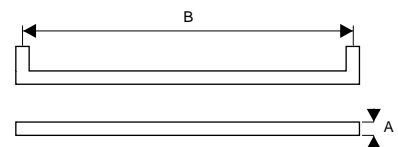

Rectangular Towel Bar

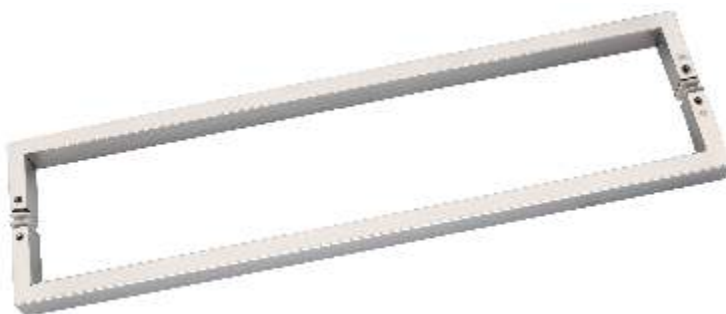
- Back to back towel bar
- Suitable for : 8-12mm glass thickness
- Bar Thickness : 25mm
- Material : Stainless Steel

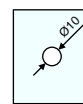

Finish: SSS, PSS, BL/PVD

Ref. No.	A	B	C	Glass Cutout
SHT450RBB	25	13	450	Ø10
SHT600RBB	25	13	600	Ø10



Glass Cutout

