

**Round Towel Bar**

- Single sided towel bar
- Suitable for : 8-12mm glass thickness
- Heavy duty fixing with low profile end cap
- Material : Stainless Steel



Finish: SSS, PSS, BL/PVD

Ref. No.	A	B	Glass Cutout
SHT450	22	450	Ø12
SHT600	22	600	Ø10

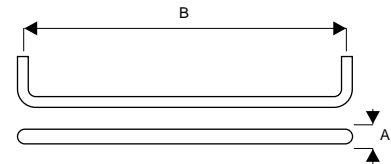
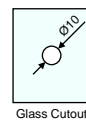
**Square Towel Bar**

- Single sided towel bar
- Suitable for : 8-12mm glass thickness
- Bar Thickness : 19mm
- Material : Stainless Steel



Finish: SSS, PSS, BL/PVD

Ref. No.	A	B	Glass Cutout
SHT450SQ	19	450	Ø12
SHT600SQ	19	600	Ø10

