

CYD Series

- Solid brass body
- Top pins made of solid brass
- Key manufactured from cupronickel
- Each side 4 anti drill pins
- Tested to 100,000 cycles
- Supplied with SS 304 bolt

- Keyed Alike suites available
- Bespoke master keyed systems assembled in-house at EuroArt (UK) Ltd.
- Approx 1000 differs available for a straight MK suite with no sub suites
- Full records kept for replacements and future extensions
- Supplied with three 2.2mm keys

Double Cylinder

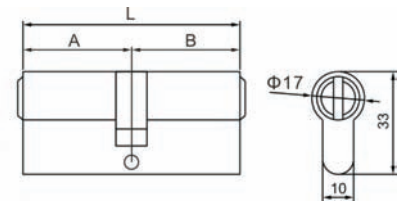

Ref. No.	Size
• CYD260	: 60mm
• CYD270	: 70mm
• CYD280	: 80mm
• CYD290	: 90mm
• CYD2100	: 100mm

Key and Turn Cylinder

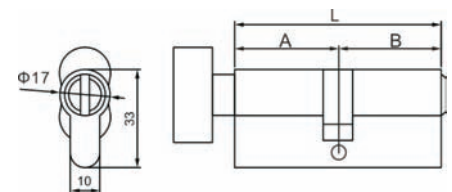
Ref. No.	Size
• CYD360	: 60mm
• CYD370	: 70mm
• CYD380	: 80mm
• CYD390	: 90mm

Single Cylinder

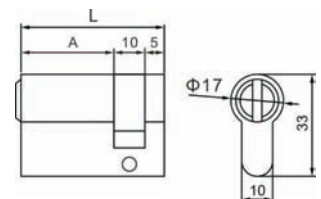
Ref. No.	Size
• CYD145	: 45mm
• CYD150	: 50mm

Finish: SN, MAB, PC, SB, PB, MBL
BS EN 1303 Classification

1	6	0	B	0	C	4	0
---	---	---	---	---	---	---	---